

**Equipment List**

Item	Description	Count
A	HVAC, Wall Mount Unit w/ Thermostat	1
B	Water Heater	1
C	48" Lavatory w/ Sink, Light, Mirror & Towel Bar	1
D	32"x32" Shower Stall w/ Privacy Curtain	1
E	Commode w/ Paper Holder & Wall Cabinet (3630)	1
F	Exhaust Fan w/ Shutter	1
G	Queen Bed w/ Mattress & Box Springs	1
H	Nightstand w/ Lamp	1
J	Closet shelf W/ Hanging Rod, 3 LF	1
K	Dining Table, 30"x48" w/ 4 Chairs	1
L	Sofa, Full Size	1
M	Storage Closet (U248424)	1
N	7'-10" Desktop w/ Drawers, Drawer Base (VDB24) Swivel Chair & Wall Cabinet (W2430)	1

**Equipment List**

Item	Description	Count
P	9'-10" Desktop w/ Drawers, Drawer Base (VDB24) & Wall Cabinet (W2430)	1
Q	File Cabinet, 2 Drawer	1
R	Refrigerator, 15 cu.ft.	1
S	Range w/ Microwave/Hood Combo Below Cabinet (W3012)	1
T	Base & Wall Cabinet (BB48 / WB4830)	1
U	Kitchen Sink W/ Base & Wall Cabinet (SB36 / W3612)	1
V	Drawer Base & Wall Cabinet (DB12 / B1230)	1
W	Base & Wall Cabinet (B24 / W2430)	1
X	Wall Cabinet (W1230)	1
Y	Stacked Washer / Dryer	1
Z	Smoke Detector	4
A1	Baseboard Heater	1

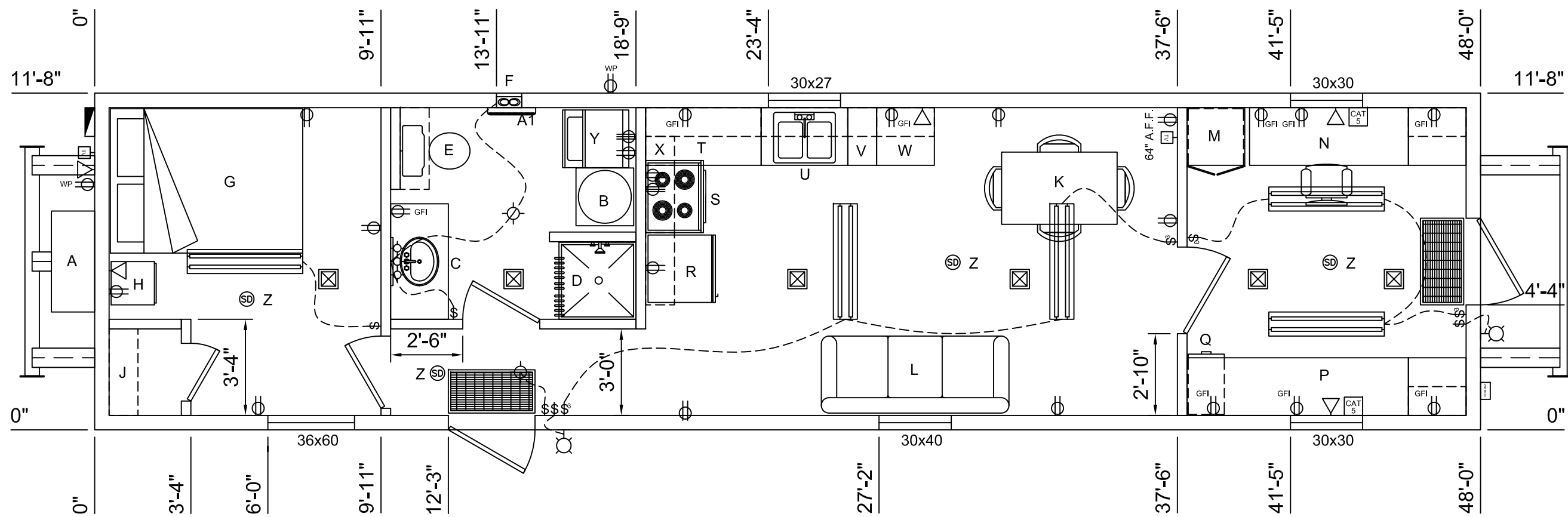

THE INFORMATION HEREIN IS THE PROPERTY OF ARIES AND IS COPYRIGHTED MATERIAL. THIS DOCUMENT MAY NOT BE DISTRIBUTED TO ANY OTHER THIRD PARTY WITHOUT THE EXPRESS WRITTEN CONSENT OF ARIES BUILDING SYSTEMS, LLC.

**ARIES BUILDING SYSTEMS, LLC**  
 1919 MUELLER LANE TROY, TEXAS 76579  
 PHONE: 254-938-0800 FAX: 254-938-2762  
 www.ariesbulldings.com

**CUSTOMER APPROVAL SIGNATURE:** \_\_\_\_\_  
 DATE: \_\_\_\_\_

REVISIONS

**TOOLPUSHER UNIT**  
 1248MSTP-1B10  
**FLOOR PLAN**  
 12' x 48' - 576 SF

DRAWING SCALE: N.T.S.  
 DRAWN BY: DH CHECK BY: \_\_\_\_\_  
 DATE: 12/14/12 APP'D BY: \_\_\_\_\_  
 DRAWING NUMBER: DC-010713-01-H-100 REV: 0