

Equipment List		
Item	Description	Count
A	HVAC, Wall Mount Unit w/ Thermostat	7
B	Cooler Condensing Unit w/ Evaporator	1
C	Freezer Condensing Unit w/ Evaporator	1
D	Electric / Instant Water Heaters	5
E	Exhaust Fan w/ Shutter	2
F	Commode w/ Paper Holder	2
G	36" Lavatory w/ Light & Mirror (VSB36)	1
H	Mop Sink, 24"x24"	1
J	Wire Shelving, 24"x48"	11
K	3 Compartment Sink w/ Drainboards	1
L	Wire Shelving, 18"x48", Epoxy Coated	14
M	6 Burner Range w/ Griddle & 2 Ovens	1
N	36" Charbroiler w/ 36"x30" Kitchen Equip. Stand	1
P	Deep Fryer, Double Basket, Floor Mounted	1
Q	Convection Oven	1
R	Ansul System w/ Bottle Rack	1
S	Range Hood w/ Grease Filters & Exhaust Fan	15 LF

Equipment List		
Item	Description	Count
T	Hand Washing Sink	1
U	Bun Rack	3
V	Proofer Box	1
W	Bakers Table w/ 3 Ingredient Bins	1
X	Mixer, 30 Quart, Floor Mounted	1
Y	Refrigerator, 23 cu.ft.	1
Z	2 Compartment Sink w/ Drainboards & Garbage Disposal	1
A1	Work Table, 30"x60" w/ Drawers & Shelf Below	2
A2	Steam Table, 5 Hole	1
A3	Cold Table	1
A4	Work Table, 30"x48" w/ Drawers & Shelf Below	5
A5	Food Slicer	1
A6	Vegetable Sink	1
A7	Tray Slide, 3 Tube x 12 LF	1
A8	Ice Machine	1
A9	Garbage Can	2
A10	Juice Dispenser, Twin Tank	1

Equipment List		
Item	Description	Count
A11	Water Cooler	1
A12	Dining Table, 30"x96" w/ 8 Chairs	18
A13	Soiled Dish Table	1
A14	Pass-Thru Dishwasher w/ Hood & Booster Heater	1
A15	Clean Dish Table	1
A16	Commode w/ Partitions, Door & Paper Holder	2
A17	Urinal w/ Partition	2
A18	123" Lavatory Cabinet w/ 4 Sinks, Lights & Mirrors	1
A19	12"x72" Bench w/ 12 Hooks Above	2
A20	Lavatory, Wall Mounted w/ Light & Mirror	1
A21	42" Flat Screen TV w/ Wall Mounting Bracket	3
A22	4' Pot Rack w/ Hooks	2
A23	12"x48" S/S Shelf w/ Hooks	5
A24	Dirty Dish Dolly	1
A25	Utensil / Dish Cart	2
A26	Refrigerated Merchandizer	1
A27	Baseboard Heater	12

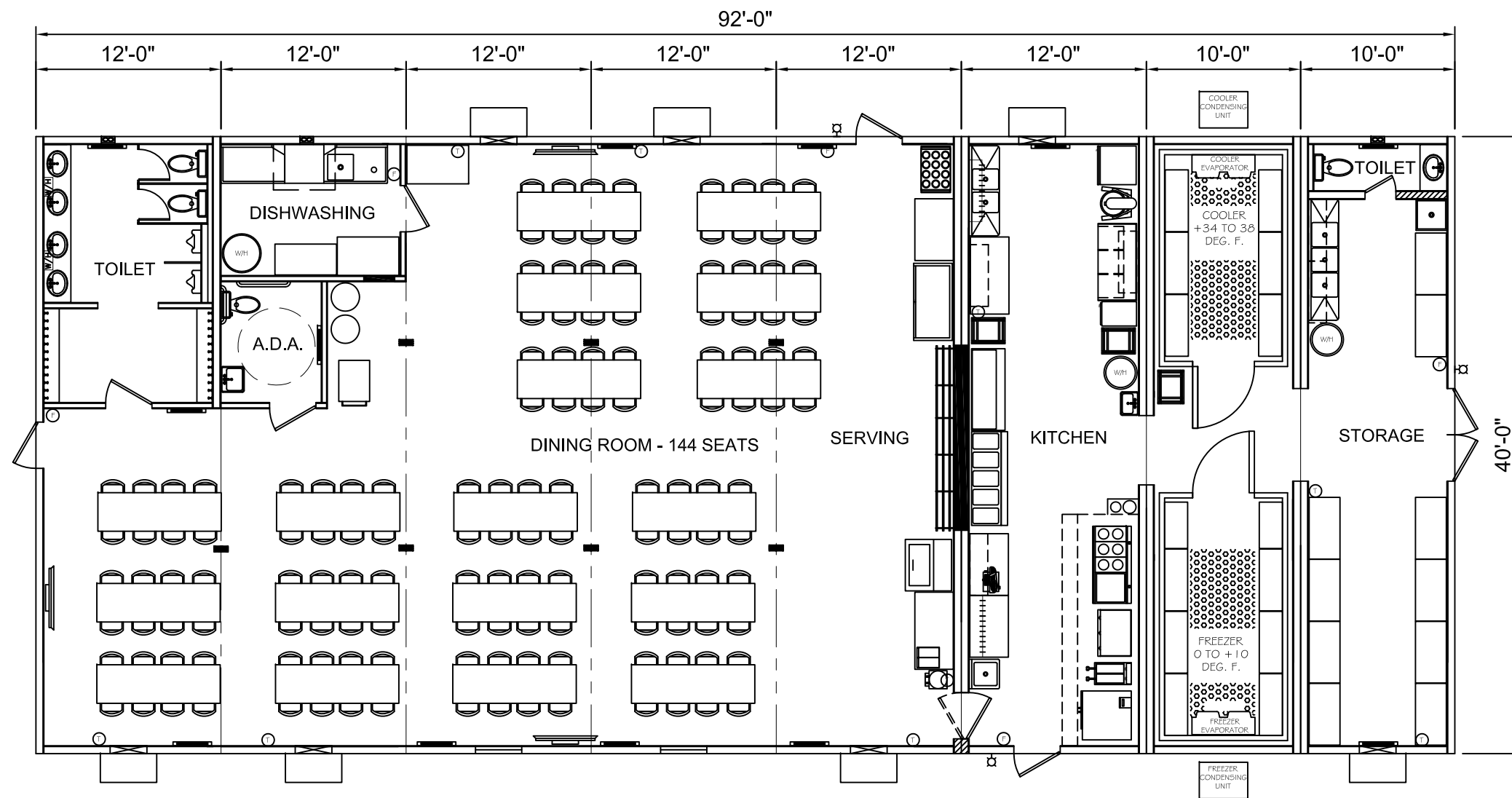

THE INFORMATION HEREIN IS THE PROPERTY OF ARIES AND IS COPYRIGHTED MATERIAL. THIS DOCUMENT MAY NOT BE DISTRIBUTED TO ANY OTHER THIRD PARTY WITHOUT THE EXPRESS WRITTEN CONSENT OF ARIES BUILDING SYSTEMS, LLC.

ARIES BUILDING SYSTEMS, LLC 1919 MUELLER LANE TROY, TEXAS 76579 PHONE: 254-938-0800 FAX: 254-938-2762 www.ariesbuildings.com	CUSTOMER APPROVAL SIGNATURE: _____ DATE: _____	REVISIONS <table border="1"> <tr><td> </td><td> </td><td> </td><td> </td></tr> <tr><td> </td><td> </td><td> </td><td> </td></tr> <tr><td> </td><td> </td><td> </td><td> </td></tr> <tr><td> </td><td> </td><td> </td><td> </td></tr> </table>																	4092 MSKD-CC KITCHEN / DINING COMPLEX FLOOR PLAN 40' x 92' - 3680 SF	DRAWING SCALE: N.T.S. DRAWN BY: DH CHECK BY: _____ DATE: 01/16/13 APP'D BY: _____ DRAWING NUMBER: DC-011613-02-H-200 REV: 0